

WEKIWA SPRINGS STATE PARK



- ○ ○ ○ ○ MAIN HIKING TRAIL - WHITE BLAZE
- ● ● ● ● HORSE TRAIL - GREEN BLAZE
- ■ ■ ■ ■ EAST-WEST CROSSTRAIL & SPUR TRAILS- BLUE BLAZE
- ★ ★ ★ ★ ★ NORTH-SOUTH CROSSTRAIL- YELLOW BLAZE
- ◆ ◆ ◆ ◆ ◆ VOLKSMARCH TRAIL- ORANGE BLAZE
- ■ ■ ■ ■ BICYCLE TRAIL (SHARED TRAIL) - RED BLAZE

① ② etc. NUMBERED POSTS (FOR IDENTIFYING LOCATION)

HORSE CORRAL

TRAIL HEAD

CAMP SITE

PARKING

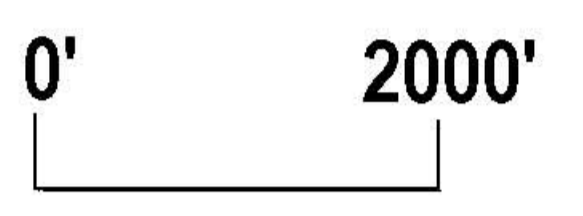

**Avoid getting lost...
STAY ON MARKED TRAILS**

Park Boundary (fence)

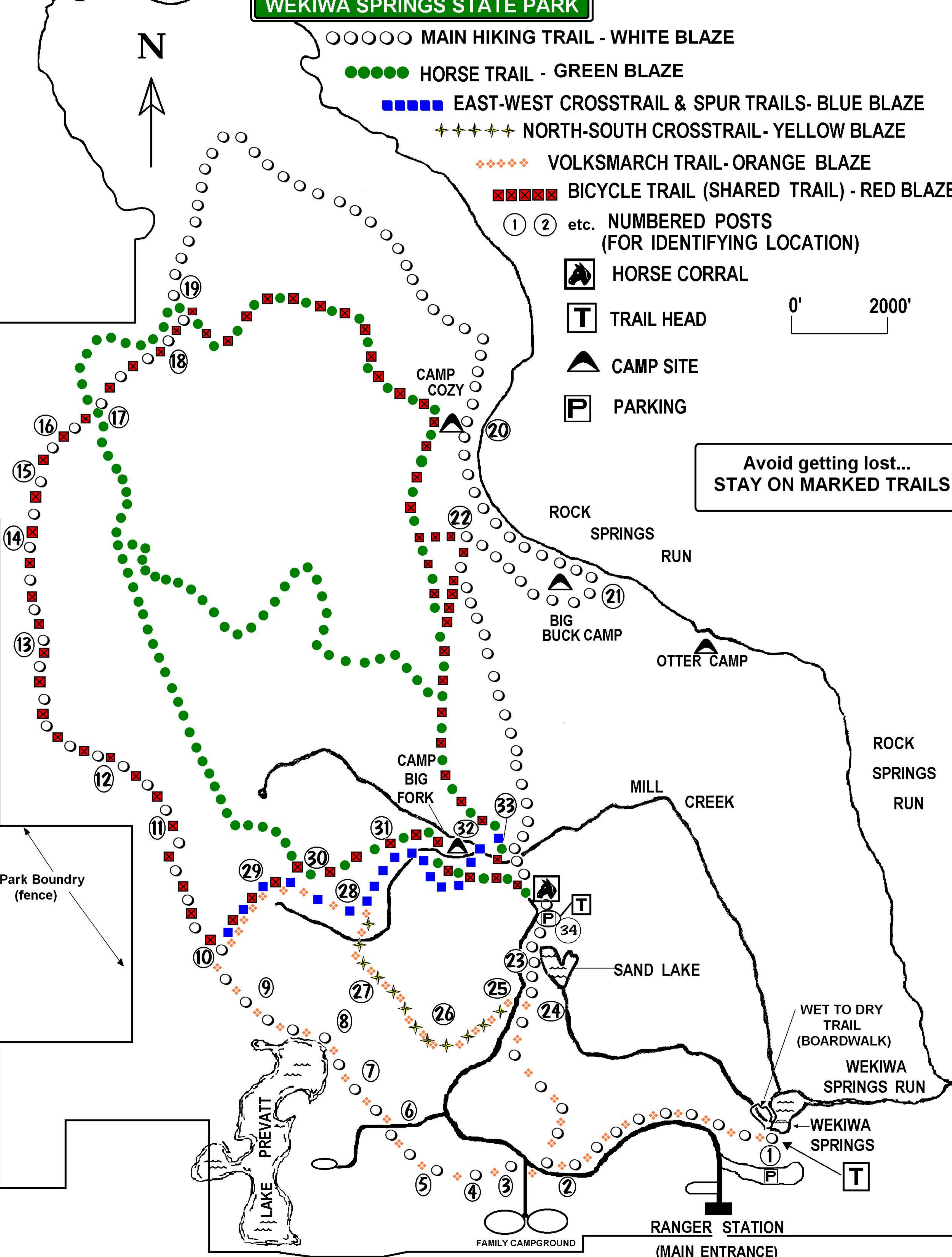
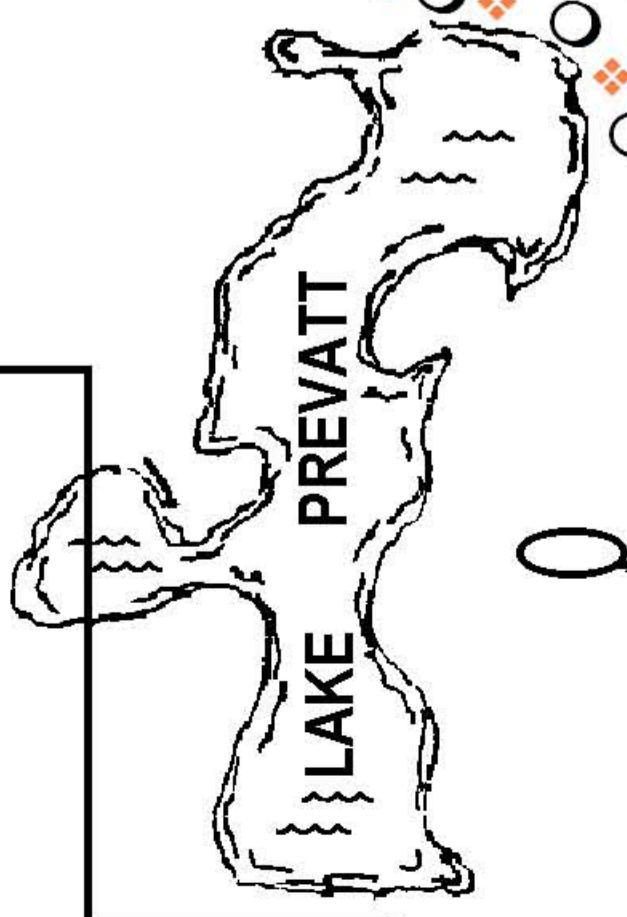
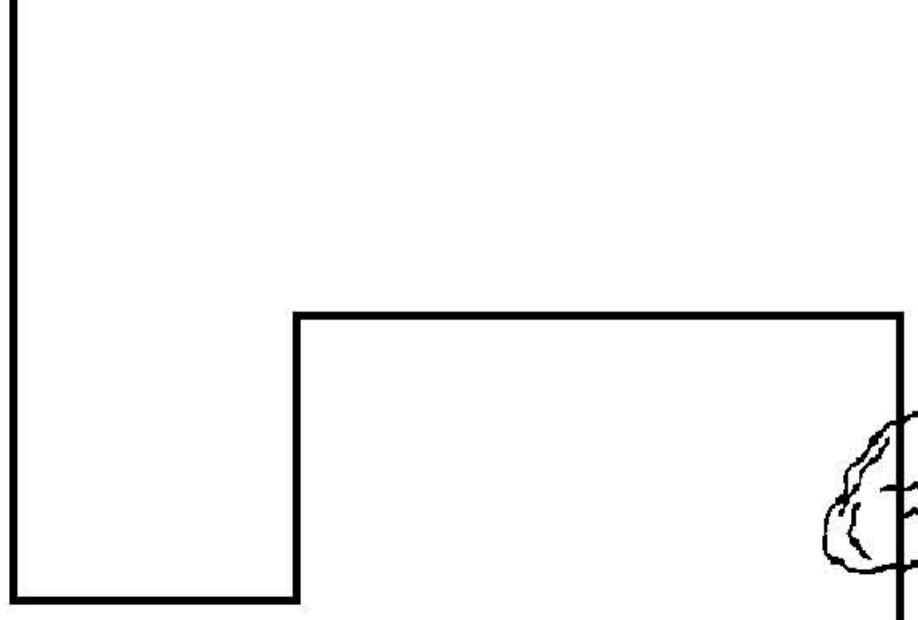

RANGER STATION (MAIN ENTRANCE)

FAMILY CAMPGROUND

WET TO DRY TRAIL (BOARDWALK)

WEKIWA SPRINGS RUN

SAND LAKE

MILL CREEK

ROCK SPRINGS RUN

OTTER CAMP

BIG BUCK CAMP

ROCK SPRINGS RUN

CAMP COZY

CAMP BIG FORK

LAKE PREVATT